

- 100% Critical Dimensions to be inspected 100%.
- Critical Dimensions.
- <SPC> Critical Dimensions. To determine Cmk & Cpk.

UNLESS OTHERWISE SPECIFIED : DIMENSIONS ARE IN MILLIMETERS

TOLERANCES:
ISO 2768-1 f
ISO 2768-2 H

ORDER / ARTICLE NO. 82-00932

CONFIDENTIAL Customer Drawing

RoHS compliant acc. to directive 2011/65/EU Specification/Drawing subject to alteration without prior notice.
The information contained in this drawing is the sole property of YAMAICHI ELECTRONICS DEUTSCHLAND GMBH. Any reproduction in part or whole without the written permission of YAMAICHI ELECTRONICS DEUTSCHLAND GMBH is prohibited.

REVISION	DESCRIPTION	ID	REV. DATE
003		M419	13.09.2023
002		T080	27.07.2022



DO NOT SCALE DRAWING Description: Y-SPE Jack 180° 1 port acc. to IEC 63171-6, PCB

Purchase No.: Y-SPE6-J1STTFP-01-NOALR1T

Drawing No.: Customer-P3946A20 REVISION: 003

Yamaichi acts with all markings of the product exclusively on behalf of the customer as service provider and not as distributor. Yamaichi is not aware of the customer's end use/application. The customer indemnifies Yamaichi from any liability towards third parties in connection with the marking - with the exception of the legal exclusions of liability according to § 309 No. 7 BGB.

for Y-SPE Jack IP20

RECOMMENDED PCB LAYOUT TOP VIEW

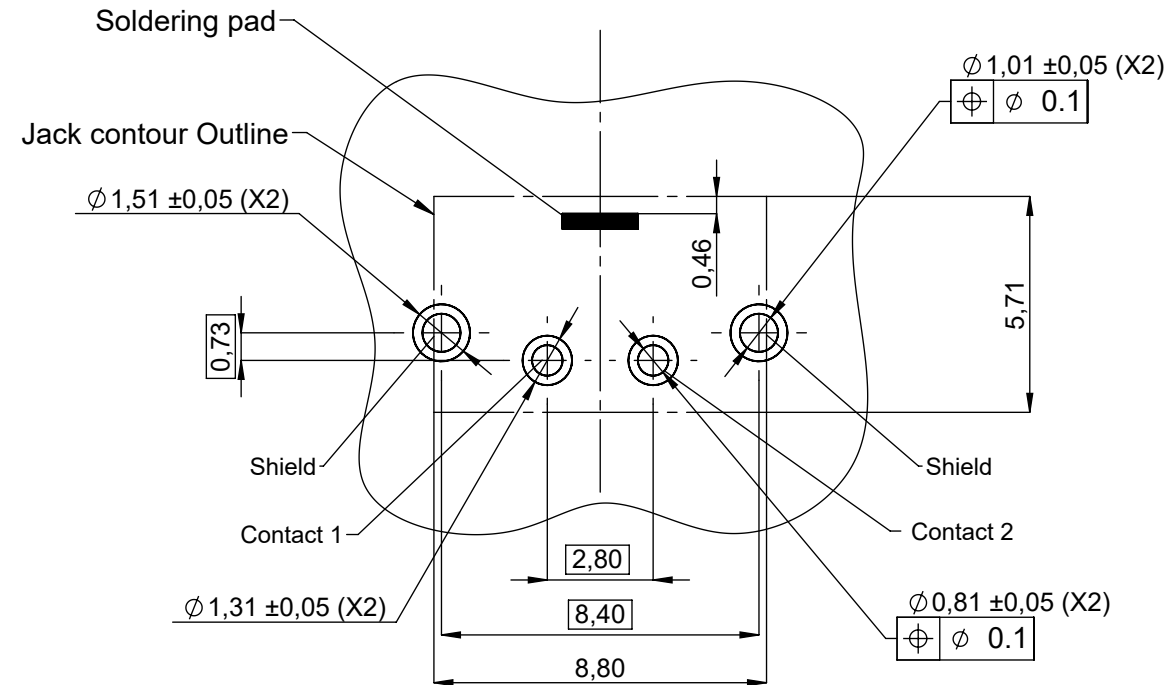

RECOMMENDED PANEL CUTOUT

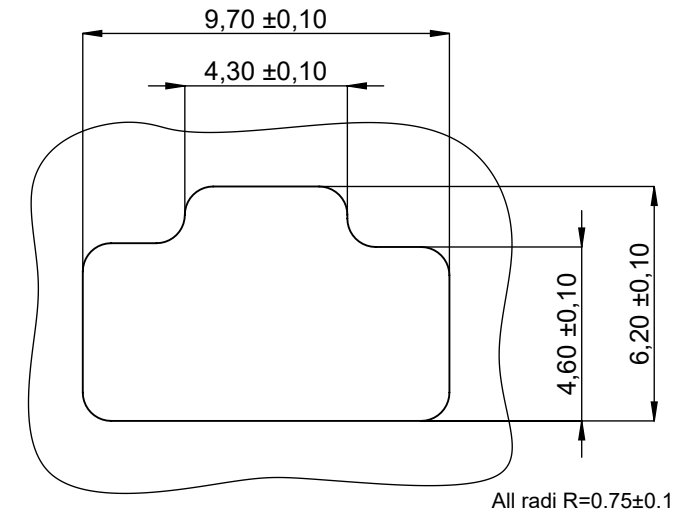

NOTE:

Drill hole = Connector diameter + 0.2mm
exemple 0.5 + 0.2 = 0.7mm

PAD hole = Drill hole + 0.5 mm min
exemple: 0.7 + 0.5 = 1.2mm

Recommended PCB thickness :
1.6 ± 0.16mm

Panel thickness: 3mm MAX

Yamaichi acts with all markings of the product exclusively on behalf of the customer as service provider and not as distributor. Yamaichi is not aware of the customer's end use/application. The customer indemnifies Yamaichi from any liability towards third parties in connection with the marking - with the exception of the legal exclusions of liability according to § 309 No. 7 BGB.

100%	Critical Dimensions to be inspected 100%.	CONFIDENTIAL	Customer Drawing													
	Critical Dimensions.		RoHS compliant acc. to directive 2011/65/EU													
<SPC>	Critical Dimensions. To determine Cmk & Cpk.		Specification/Drawing subject to alteration without prior notice.													
UNLESS OTHERWISE SPECIFIED : DIMENSIONS ARE IN MILLIMETERS		The information contained in this drawing is the sole property of YAMAICHI ELECTRONICS DEUTSCHLAND GMBH. Any reproduction in part or whole without the written permission of YAMAICHI ELECTRONICS DEUTSCHLAND GMBH is prohibited.														
TOLERANCES: ISO 2768-1 f ISO 2768-2 H		<table border="1"> <thead> <tr> <th>REVISION</th> <th>DESCRIPTION</th> <th>ID</th> <th>REV. DATE</th> </tr> </thead> <tbody> <tr> <td>003</td> <td></td> <td>M419</td> <td>13.09.2023</td> </tr> <tr> <td>002</td> <td></td> <td>T080</td> <td>27.07.2022</td> </tr> </tbody> </table>			REVISION	DESCRIPTION	ID	REV. DATE	003		M419	13.09.2023	002		T080	27.07.2022
REVISION	DESCRIPTION	ID	REV. DATE													
003		M419	13.09.2023													
002		T080	27.07.2022													
ORDER / ARTICLE NO. 82-00932		DO NOT SCALE DRAWING Description: Y-SPE Jack 180° 1 port acc. to IEC 63171-6, PCB Purchase No.: Y-SPE6-J1STTFP-01-NOALR1T Drawing No.: Customer-P3946A20														
ANGLE PROJECTION: FIRST 		<table border="1"> <thead> <tr> <th>ID</th> <th>DATE</th> <th>REVISION</th> </tr> </thead> <tbody> <tr> <td>CREATED T006</td> <td>11.11.2021</td> <td></td> </tr> <tr> <td>MODIFIED M419</td> <td>18.10.2023</td> <td></td> </tr> <tr> <td>RELEASED M189</td> <td>18.10.2023</td> <td></td> </tr> </tbody> </table>			ID	DATE	REVISION	CREATED T006	11.11.2021		MODIFIED M419	18.10.2023		RELEASED M189	18.10.2023	
ID	DATE	REVISION														
CREATED T006	11.11.2021															
MODIFIED M419	18.10.2023															
RELEASED M189	18.10.2023															
WEIGHT:		SCALE: 5:1 SHEET 2 OF 3 DIN A3 - ASSEMBLY														

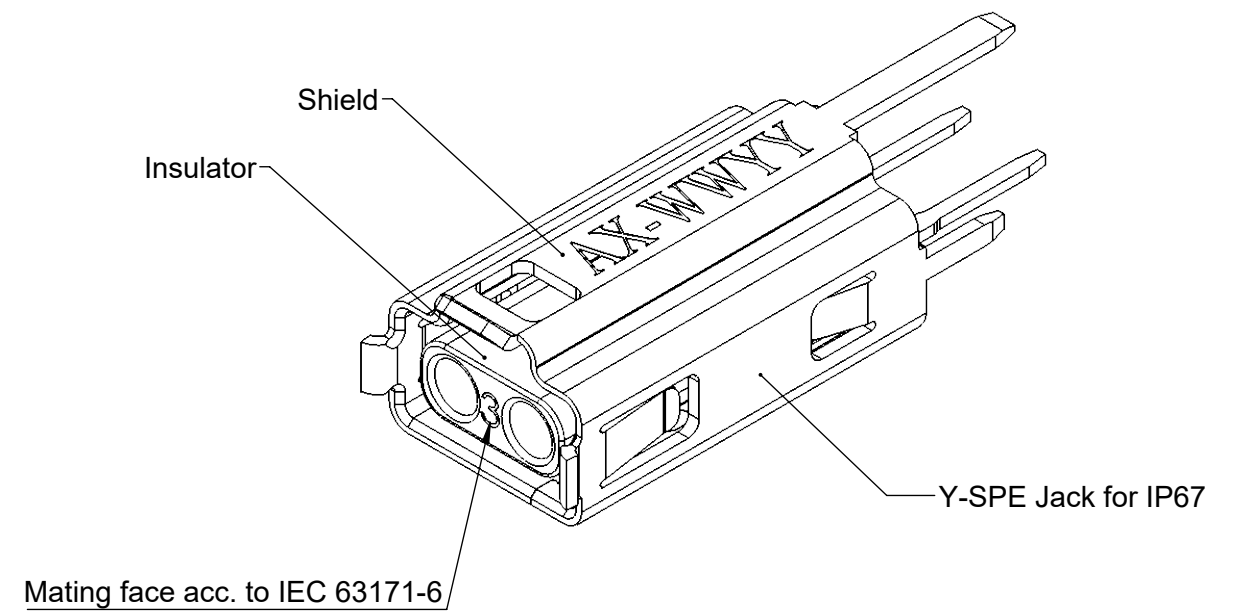
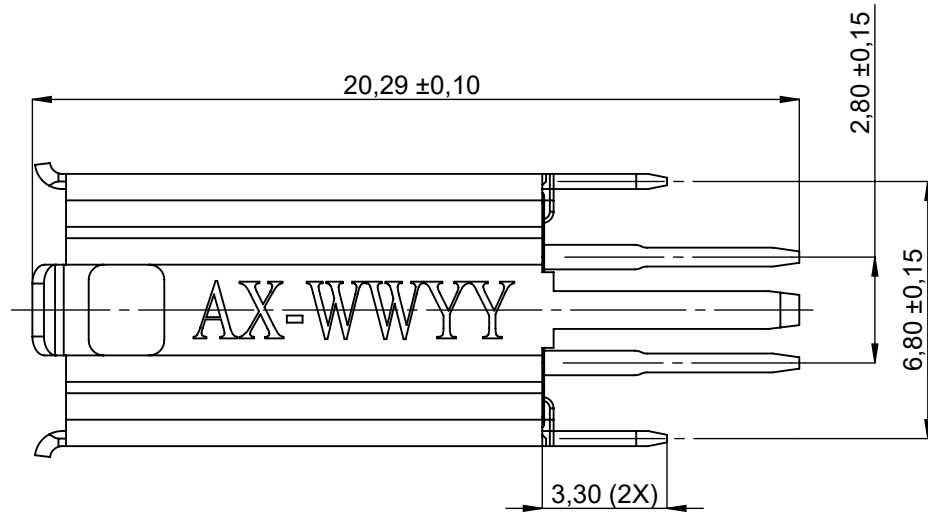
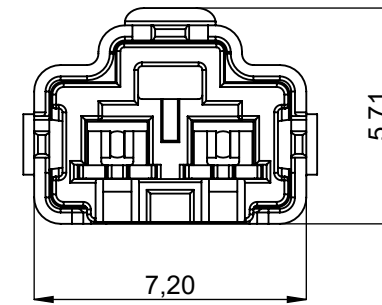
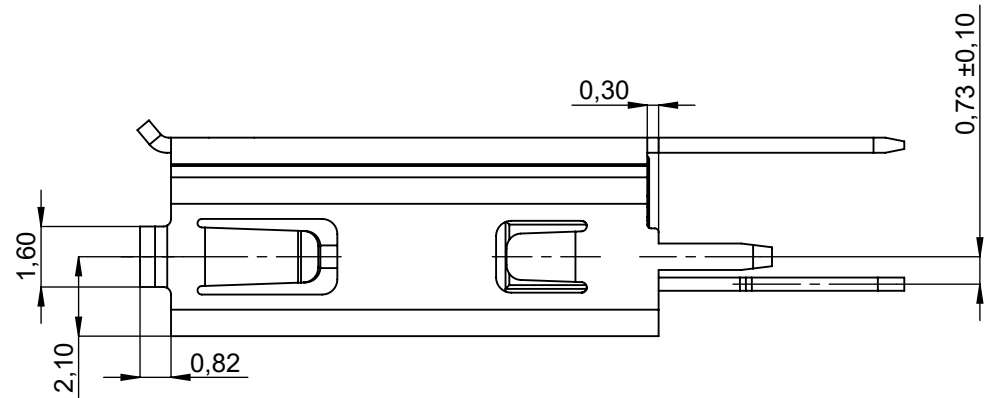

- 100% Critical Dimensions to be inspected 100%.
- Critical Dimensions.
- <SPC> Critical Dimensions. To determine Cmk & Cpk.

UNLESS OTHERWISE SPECIFIED : DIMENSIONS ARE IN MILLIMETERS

TOLERANCES:
ISO 2768-1 f
ISO 2768-2 H

ORDER / ARTICLE NO. 82-00933

CONFIDENTIAL Customer Drawing

RoHS compliant acc. to directive 2011/65/EU Specification/Drawing subject to alteration without prior notice.
The information contained in this drawing is the sole property of YAMAICHI ELECTRONICS DEUTSCHLAND GMBH. Any reproduction in part or whole without the written permission of YAMAICHI ELECTRONICS DEUTSCHLAND GMBH is prohibited.

REVISION	DESCRIPTION	ID	REV. DATE
003		M419	13.09.2023
002		T080	27.07.2022



DO NOT SCALE DRAWING
Description: Y-SPE Jack 180° 1 port acc. to IEC 63171-6, PCB

Purchase No.: Y-SPE6-J1STTFP-01-NOALR1T

Drawing No.: Customer-P3946A20 REVISION: 003

WEIGHT: SUBREV01 SCALE: 5:1 SHEET 3 OF 3 DIN A3 - ASSEMBLY

Yamaichi acts with all markings of the product exclusively on behalf of the customer as service provider and not as distributor. Yamaichi is not aware of the customer's end use/application. The customer indemnifies Yamaichi from any liability towards third parties in connection with the marking - with the exception of the legal exclusions of liability according to § 309 No. 7 BGB.