

Y-Con Plug-21  
4 signal contacts  
2 power contacts

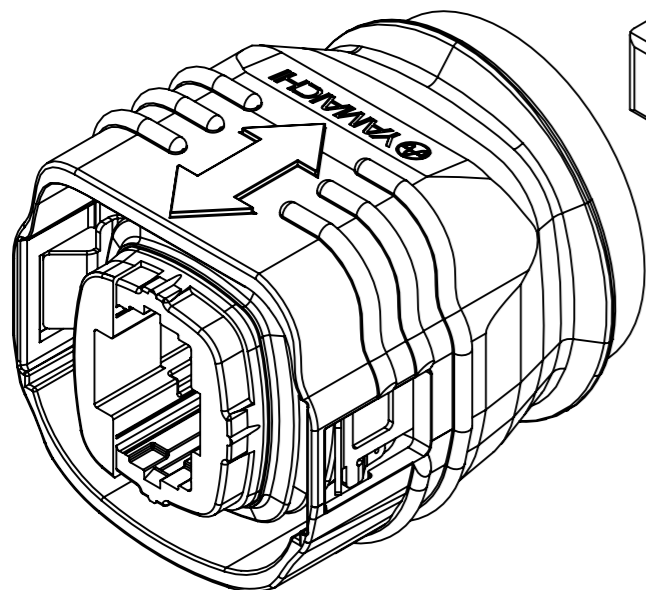
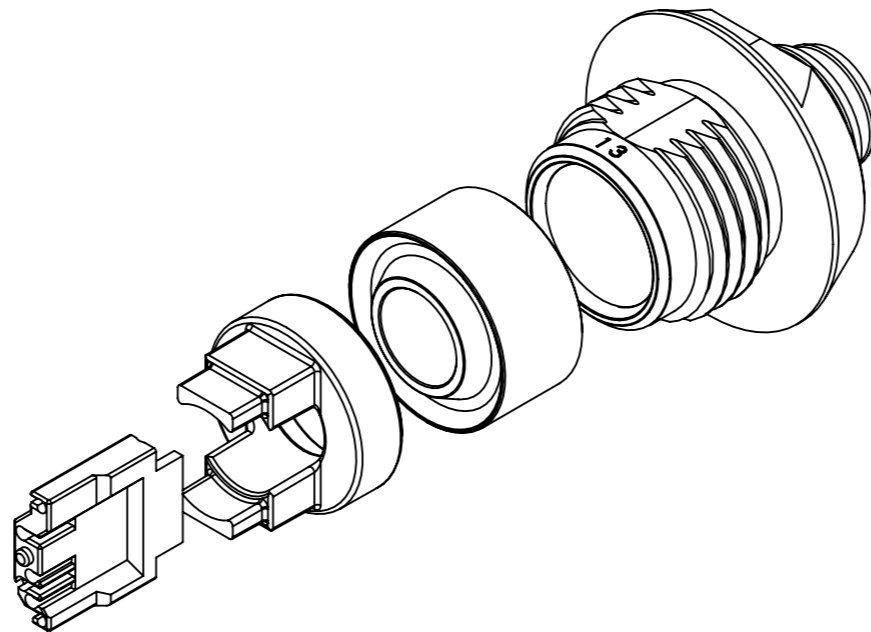

For more technical data see drawings  
82-00806 (Customer-P3021A33) and  
82-00053 (Customer-P(090)A11)

- 100% Critical Dimensions to be inspected 100%.
- Critical Dimensions.
- <SPC> Critical Dimensions. To determine Cmk & Cpk.

UNLESS OTHERWISE SPECIFIED :  
DIMENSIONS ARE IN MILLIMETERS

TOLERANCES:

**CONFIDENTIAL** **Customer Drawing**

RoHS compliant acc. to directive 2011/65/EU Specification/Drawing subject to alteration without prior notice.

The information contained in this drawing is the sole property of YAMAICHI ELECTRONICS DEUTSCHLAND GMBH. Any reproduction in part or whole without the written permission of YAMAICHI ELECTRONICS DEUTSCHLAND GMBH is prohibited.

REVISION DESCRIPTION	ID	REV. DATE



ORDER / ARTICLE NO. 82-00735

DO NOT SCALE DRAWING

Description: IP67 EMI RJ45 Field Kit with Y-ConCover-40-PP, Y-ConPlug-21

Purchase No.: Y-CONKIT-COV-40-PP-PL-21

Drawing No.: **Customer-P3021A40** REVISION: **001**

ANGLE PROJECTION:	CREATED	ID	DATE
FIRST	M161	M161	27.04.2021
	M161	M161	26.10.2021
	M189	M189	26.10.2021

WEIGHT:

SUBREV01

SCALE: 1:2

SHEET 1 OF 1

DIN A3 - ASSEMBLY

Yamaichi acts with all markings of the product exclusively on behalf of the customer as service provider and not as distributor. Yamaichi is not aware of the customer's end use/application. The customer indemnifies Yamaichi from any liability towards third parties in connection with the marking - with the exception of the legal exclusions of liability according to § 309 No. 7 BGB.